

RECORD OF LAND CORNER MONUMENTATION

CORNER: NW1/16 Cor. Sec. 2 T.13S., R.33E., W.M.

ORIGINAL SURVEY BY: CORNER NOT

CONTRACT NUMBER: PREVIOUSLY

CONTRACT DATE: ESTABLISHED

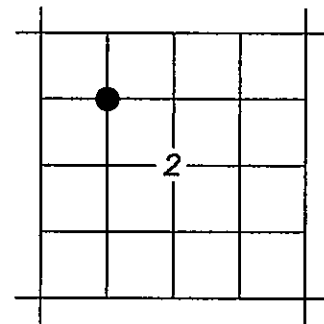

ORIGINAL G.L.O. DESCRIPTION: None, Corner not previously established.

EVIDENCE FOUND: None, Corner not previously established.

DESCRIPTION OF MONUMENT AND ACCESSORIES SET:

At the corner point as determined by survey, I set a 5/8"x30" iron pin with attached 2 1/2" aluminum cap marked as shown below. Built a 2 ft. mound of stone around pin. SEE RECORD MAP OF SURVEY 2068 FOR DETAILS ON THE SUBDIVISION OF SECTION.

FROM WHICH, I set the following reference points:

A 5/8"x15" iron pin, driven to bedrock bears N.46°57'E., 10.18 ft., with attached yellow plastic cap marked BENCHMARK SURVEYING

A 5/8"x24" iron pin, driven to bedrock bears S.63°02'E., 10.38 ft., with attached yellow plastic cap marked BENCHMARK SURVEYING

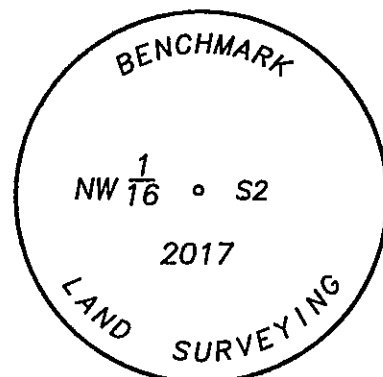

Used RTK GPS to measure RP's. Bearings to RP's are based on Record Map of Survey No. 2068.

RESTORATION BY:

Michael C. Springer
Benchmark Land Surveying
217 N. Canyon Blvd.
John Day, OR, 97845

Surveyed April 4, 2017

RECEIVED AND FILED
GRANT COUNTY SURVEYOR

APR 6 2015

BY: 

REGISTERED
PROFESSIONAL
LAND SURVEYOR

OREGON
JULY 9, 2002
MICHAEL C. SPRINGER
#70918

EXPIRES: 6/30/2018